

# Flowmeter with analog output

## DUM/TA

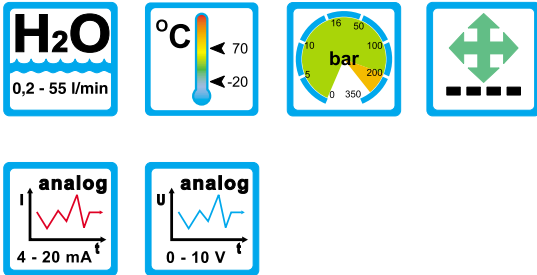

### Range of Application

#### Operation

- Float measuring principle

#### Application

- Cooling systems and cooling circuits
- Medicine technology
- Pharma industry
- Chemical industry
- Research and development

#### Features

- Universal mounting
- Analog output (4 - 20 mA and 0 - 10 V)
- High electromagnetic compatibility
- Zero and span of the measuring range separately adjustable (2 potentiometer)
- High pressure resistance
- Threaded connection special threads on request

#### Installation hints

- The operating instructions for DUM/TA must be observed!
- Download: [www.meister-flow.com](http://www.meister-flow.com)

### Operating data

- Operating pressure: PN 200 bar (Brass-Version)  
PN 300 bar (Stainless Steel-Version)
- Pressure drop: 0,02 - 0,8 bar
- Max. temperature: 70 °C

### Measuring Ranges

Type	Flow ranges for H <sub>2</sub> O at 20 °C)		
	[l/min]	[gph]	[gpm]
DUM/TA-4	0,2 - 4	3,0 - 63,5	
DUM/TA-5	0,6 - 5	9,5 - 79,0	
DUM/TA-8	0,5 - 8	8,0 - 127,0	
DUM/TA-14	1 - 14	15,0 - 222,0	
DUM/TA-28	1 - 28	15,0 - 445,0	
DUM/TA-40	2 - 40	30,0 - 635,0	
DUM/TA-55	4 - 55	60,0 - 870,0	



# Technical data

## Mechanical drawing

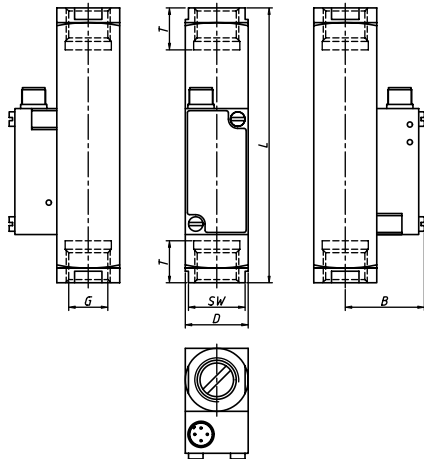

## Connection diagram

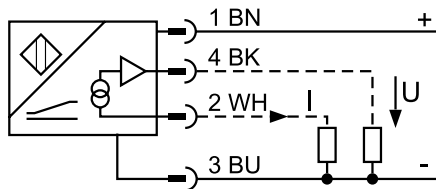

## Summary of types

Type:	Overall dimensions [mm]							Weight approx. [g]
	SW	D	B	G	DN	T	L	
<b>DUM/TA-4</b>								
<b>DUM/TA-5</b>				1/4"	8			
<b>DUM/TA-8</b>	27	30	37	3/8"	10	14	130	850
<b>DUM/TA-14</b>				1/2"	15			
<b>DUM/TA-28</b>								
<b>DUM/TA-40</b>	27	30	37	1/2"	15	14	148	900
<b>DUM/TA-55</b>				3/4"	20	16		

## Accuracy

Measuring range [A...B]:	10...50 mm (adjustable by 2 potentiometers)
Repeatability:	≤ 0,5 % of range [A...B] (≤ depending on positioner)
Linearity error:	≤ 10 % of full scale of the flowmeter

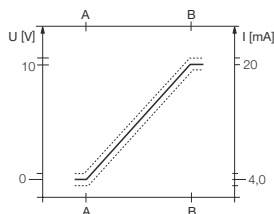

## Technical data

Temperature drift:	≤ ± 0,09 % / K
Operating temperature:	-20 °C...+70 °C
Operating voltage $U_B$ :	15...30 VDC
Residual ripple:	≤ 10 % $U_{SS}$
No-load current $I_0$ :	≤ 23 mA
Design breakdown voltage:	≤ 0,5 kV
Output function:	four wire, analog output
Short-circuit protection:	yes
Wire rupture safety / polarity reversal protection:	yes / complete
Analog output (voltage):	0...10 V

Analog output (current):	4...20 mA
Load resistance voltage output:	≥ 4,7 kΩ
Load resistance current output:	≤ 0,4 kΩ
Measuring frequency:	800 Hz
Recovery time at output:	≤ 12 ms
Housing material:	Plastic, PBT-GF20-V0
Connection:	Plug, M 12 x 1
Vibration stability:	55 Hz (1 mm)
Shock resistance:	30 x g (11 ms)
Ingress protection:	IP 67

## Materials

### Brass-Version

<b>wetted parts:</b>	
Spring:	1.4571
Gaskets:	NBR (optional FKM, EPDM) <sup>(3)</sup>

All other wetted parts: Brass nickel-plated

### Stainless Steel-Version

<b>wetted parts:</b>	
Spring:	1.4571
Gaskets:	FKM (optional NBR, EPDM) <sup>(3)</sup>

All other wetted parts: 1.4571

<sup>(3)</sup> Other gasket materials on request