

# The Industrial Range offers numerous flange combinations

The main feature of the Industrial Range is the wide choice of flange modules, manufactured according to international standards such as DIN, ANSI, BS or JIS. Available in various steel qualities, nominal sizes and pressure ratings (e.g. up to PN 315 acc. to DIN or class 2500 acc. to ANSI). Shown here are only a few typical combinations, many more possibilities can be found in the module descriptions. All types in the Standard Range shown on the previous pages can of course also be combined with industrial flanges.

Frequently used on off-shore rigs, in steam boilers and plants, power stations, chemical and petrochemical engineering, heating and refrigeration, i.e. air-conditioning technology.

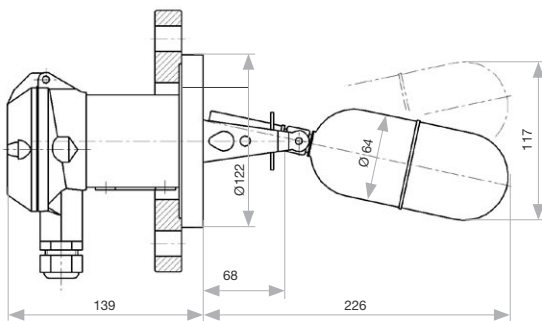
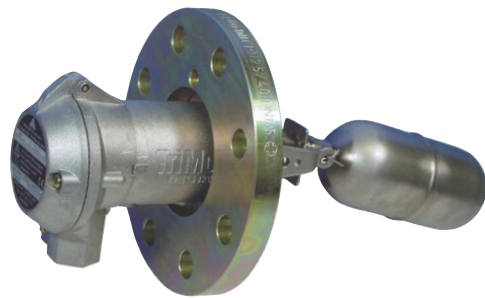

## A 22C 04 For general purpose

|                         |  |
|-------------------------|--|
| Nominal pressure        | PN 40                                    |
| Operating temperature   | 0 to 330°C                               |
| Ambient temperature     | 0 to 70°C                                |
| Density of liquid       | min. 0.7 kg/dm <sup>3</sup>              |
| Operating differential  | fixed 12 mm                              |
| Rod extension           | see page 31                              |
| Wetside material        | Stainless steel (CrNiMo)                 |
| Flange material         | Stainless steel (CrNiMo)                 |
| Seal part:              | Stainless steel (CrNiMo)                 |
| Composite flange:       | H II, zinc galvanised, yellow passivated |
| Switch housing material | Sea water resistant die cast aluminium   |
| Flange                  | DN 65, PN 40 to DIN 2635                 |
| Flange facing           | Raised face type C, DIN 2526             |
| Switch element          | Microswitch SPDT<br>silver contacts      |
| Switch rating           | 5A/250 VAC      5A/30 VDC                |
| Enclosure               | IP 65                                    |
| Weight                  | approx. 5.4 kg                           |

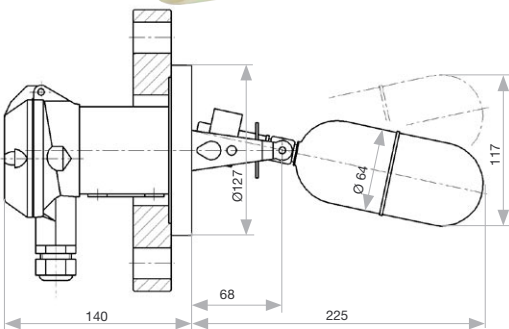
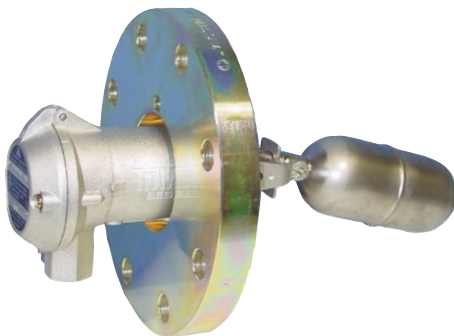

## B 132R 07 For intrinsically safe circuits and low density liquids

For certified intrinsically safe installations, approved for use in hazardous areas (see also page 37).

|                         |   |
|-------------------------|---|
| Nominal pressure        | ANSI cl. 300 lbs                              |
| Operating temperature   | 0 to 330°C                                    |
| Ambient temperature     | 0 to 70°C                                     |
| Density of liquid       | min. 0.5 kg/dm <sup>3</sup>                   |
| Operating differential  | fixed 12 mm                                   |
| Wetside material        | Stainless steel (CrNiMo)                      |
| Flange material         | Stainless steel (CrNiMo)                      |
| Seal part:              | Stainless steel (CrNiMo)                      |
| Composite flange:       | H II, zinc galvanised, yellow passivated      |
| Switch housing material | Sea water resistant die cast aluminium        |
| Flange                  | DN 3", PN cl.300 lbs ANSI B16.5               |
| Flange facing           | Raised face                                   |
| Switch element          | Microswitch SPDT<br>with gold plated contacts |
| Enclosure               | IP 65   |
| Weight                  | approx. 8.6 kg                                |

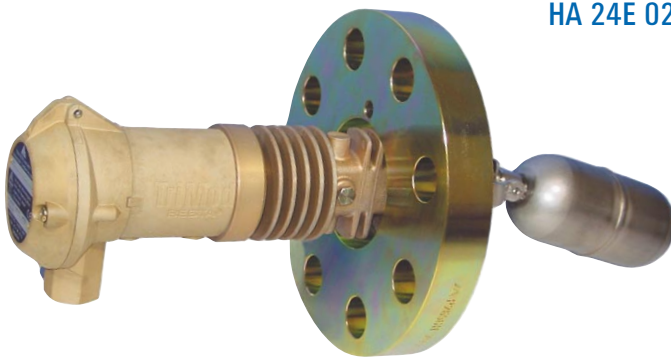

### HA 24E 02 For high temperatures

|                         |  |
|-------------------------|--|
| Nominal pressure        | PN 100   |
| Operating temperature   | 0 to 400°C   |
| Ambient temperature     | 0 to 135°C   |
| Density of liquid       | min. 0.7 kg/dm <sup>3</sup>  |
| Operating differential  | fixed 12 mm  |
| Rod extension           | see page 31  |
| Wetside material        | Stainless steel (CrNiMo)   |
| Flange material         | Seal part:<br>Stainless steel (CrNiMo)<br>Composite flange: H II, zinc galvanised, yellow passivated |
| Switch housing material | Sea water resistant die cast aluminium   |
| Flange                  | DN 65, PN 100 to DIN 2637  |
| Flange facing           | Raised face type E   |
| Switch element          | Microswitch SPDT<br>silver contacts  |
| Switch rating           | 5A/250 VAC      5A/30 VDC  |
| Enclosure               | IP 65  |
| Weight                  | approx. 9.6 kg   |

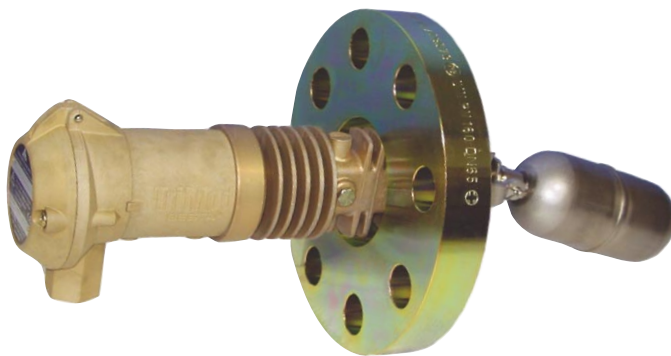
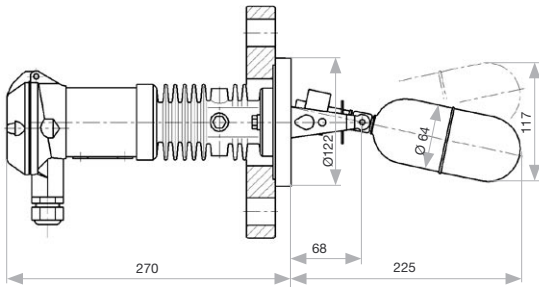

### 5TDI 22CF 041 For low temperatures and severe environmental conditions

Completely in stainless steel with fixed flange  
For certified intrinsically safe installations, approved for use in hazardous areas (see also page 37).

|                         |  |
|-------------------------|--|
| Nominal pressure        | PN 40  |
| Operating temperature   | -196°C to 270°C                                      |
| Ambient temperature     | - 10°C to 80°C                                       |
| Density of liquid       | min. 0.7 kg/dm <sup>3</sup>                          |
| Operating differential  | fixed 12 mm  |
| Wetside material        | Stainless steel (CrNiMo)                             |
| Flange material         | Stainless steel (CrNiMo)                             |
| Switch housing material | Stainless steel (CrNiMo)                             |
| Flange                  | DN 65, PN 40 to DIN 2635                             |
| Flange facing           | Raised face type C, DIN 2526                         |
| Switch element          | Inductive proximity switch<br>acc. to NAMUR/EN 50227 |
| Nominal voltage         | 8.2 VDC ±5%  |
| Operating voltage       | 5 to 25 VDC  |
| Current output          |  |
| Proximity open          | ≥2,2 mA float down                                   |
| Proximity closed        | ≤1 mA float up                                       |
| Function                |  |
| as high alarm           | at closed circuit                                    |
| as low alarm            | at operating circuit                                 |
| For inverse function    | Type 5TDIN 22CF 041                                  |
| Enclosure               | IP 67  |
| Weight                  | approx. 7.7 kg                                       |

